

TSC2.75 PITCH BREAK CONNECTIONS

33TSBUC3.5 or
43TSBUC3.5

BENT-U Pitch Break Connector

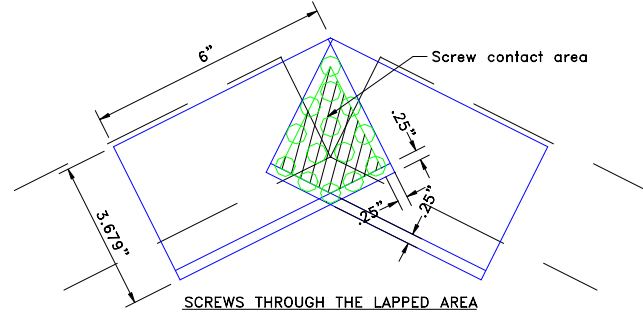

33TSHC3.5 or
43TSHC3.5

HINGED Pitch Break Connector

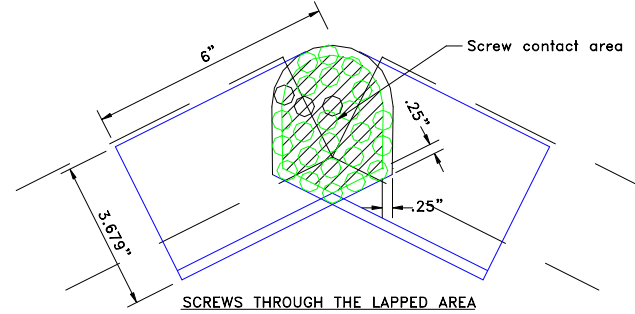

General Notes:

1. See the sealed truss engineered drawing for required screw quantities for each screw contact area.
2. Screw contact areas that coincide with other contact areas may use a common screw for both areas. This will result in a reduction in the total number of screws required at the pitch break joint.
3. All screws used to attach members as shown in these details are to be #14 AMD RED screws.

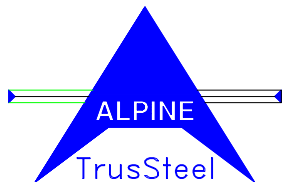
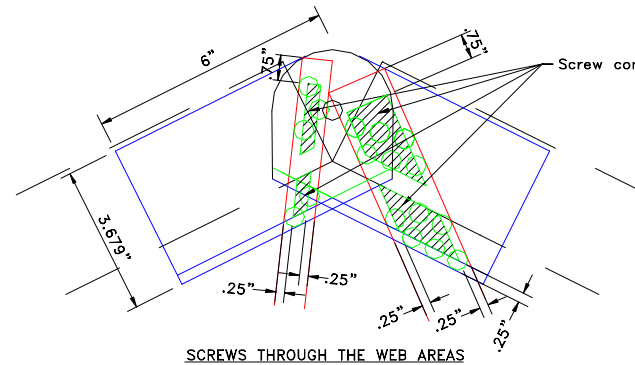
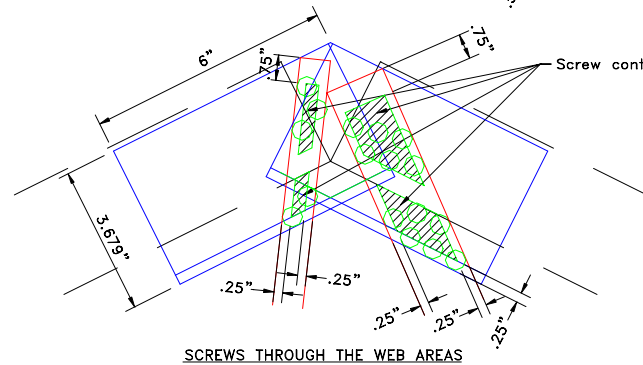
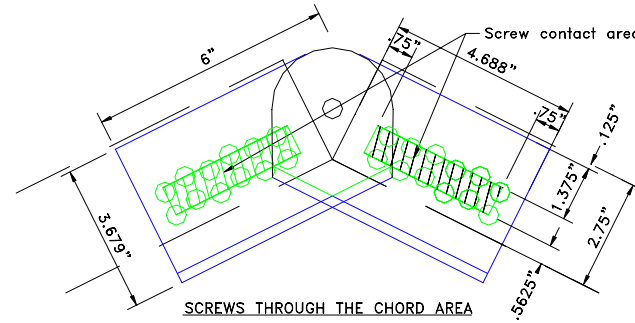
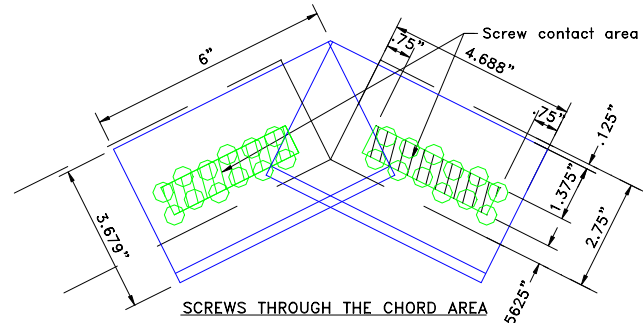

****WARNING**** TRUSSES REQUIRE EXTREME CARE IN FABRICATING, HANDLING, SHIPPING INSTALLING AND BRACING. UNLESS OTHERWISE INDICATED, TOP CHORD SHALL HAVE PROPERLY ATTACHED STRUCTURAL PANELS AND BOTTOM CHORD SHALL HAVE A PROPERLY ATTACHED RIGID CEILING.

****IMPORTANT**** FURNISH A COPY OF THIS DESIGN TO THE INSTALLATION CONTRACTOR. BRACING DEPICTED ON THIS DESIGN IS ONLY FOR LATERAL SUPPORT OF TRUSS MEMBERS TO REDUCE BUCKLING LENGTHS. ALL DESIGN, ATTACHMENT AND INSTALLATION OF TEMPORARY AND PERMANENT BRACING, TO RESIST LATERAL FORCES AND HOLD TRUSSES PLUMB, SHALL BE THE RESPONSIBILITY OF OTHERS. ALPINE ENGINEERED PRODUCTS, INC. SHALL NOT BE RESPONSIBLE FOR ANY DEVIATION FROM THIS DESIGN OR HANDLING, SHIPPING, INSTALLING, AND BRACING OF TRUSSES. AN ENGINEER'S SEAL ON THIS DRAWING APPLIES ONLY TO DESIGN OF THE TRUSS DEPICTED HERE AND SHALL NOT BE RELIED UPON IN OTHER WAY.

TrusSteel DETAIL

DATE 11/22/99

DRWG TS004

-ENG

ALPINE ENGINEERED PRODUCTS
TrusSteel Division

TSC4.00 PITCH BREAK CONNECTIONS

43TSBUC5.0 or
54TSBUC5.0
BENT-U Pitch Break Connector

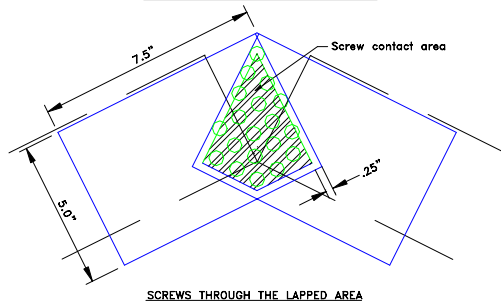

43TSHC5.0 or
54TSHC5.0
HINGED Pitch Break Connector

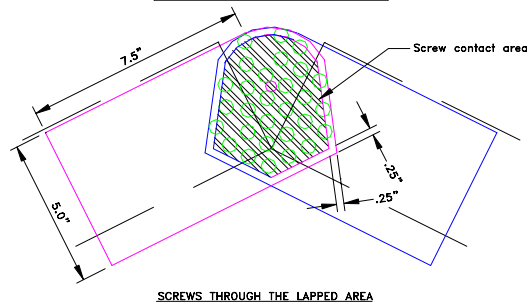

General Notes:

1. See the sealed truss engineered drawing for required screw quantities for each screw contact area.
2. Screw contact areas that coincide with other contact areas may use a common screw for both areas. This will result in a reduction in the total number of screws required at the pitch break joint.
3. All screws used to attach members as shown in these details are to be #14 AMD RED screws.

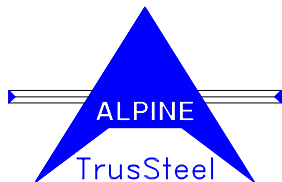
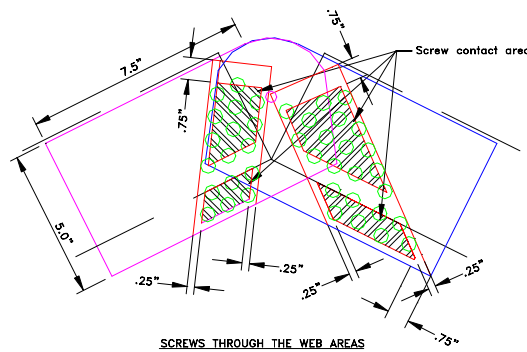
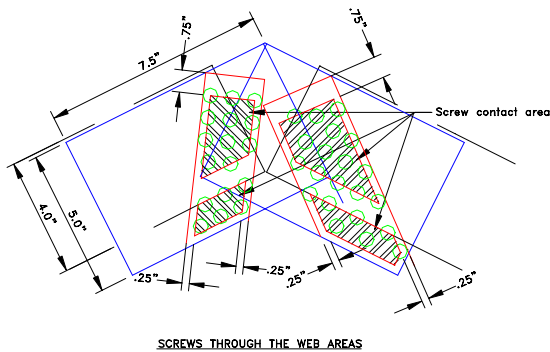
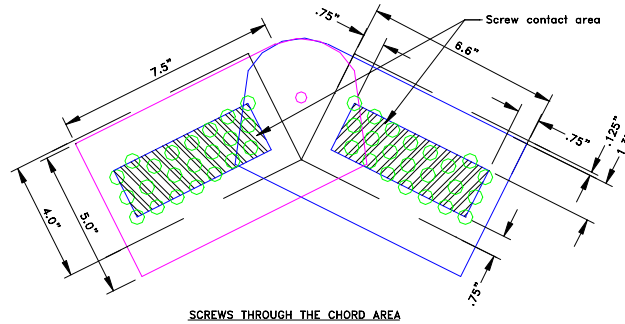
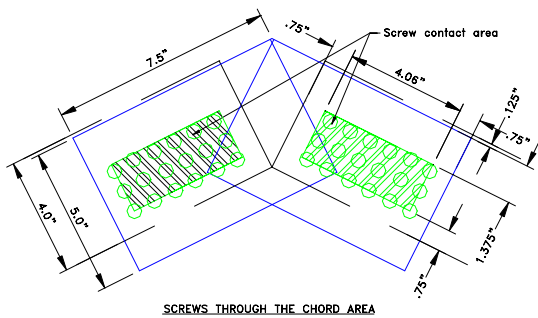

****WARNING**** TRUSSES REQUIRE EXTREME CARE IN FABRICATING, HANDLING, SHIPPING INSTALLING AND BRACING. UNLESS OTHERWISE INDICATED, TOP CHORD SHALL HAVE PROPERLY ATTACHED STRUCTURAL PANELS AND BOTTOM CHORD SHALL HAVE A PROPERLY ATTACHED RIGID CEILING.

****IMPORTANT**** FURNISH A COPY OF THIS DESIGN TO THE INSTALLATION CONTRACTOR. BRACING DEPICTED ON THIS DESIGN IS ONLY FOR LATERAL SUPPORT OF TRUSS MEMBERS TO REDUCE BUCKLING LENGTHS. ALL DESIGN, ATTACHMENT AND INSTALLATION OF TEMPORARY AND PERMANENT BRACING, TO RESIST LATERAL FORCES AND HOLD TRUSSES PLUMB, SHALL BE THE RESPONSIBILITY OF OTHERS. ALPINE ENGINEERED PRODUCTS, INC. SHALL NOT BE RESPONSIBLE FOR ANY DEVIATION FROM THIS DESIGN OR HANDLING, SHIPPING, INSTALLING, AND BRACING OF TRUSSES. AN ENGINEER'S SEAL ON THIS DRAWING APPLIES ONLY TO DESIGN OF THE TRUSS DEPICTED HERE AND SHALL NOT BE RELIED UPON IN OTHER WAY.

TRUSSTEEL DETAIL
DATE 11/22/99
DRWG TS016
-ENG
ALPINE ENGINEERED PRODUCTS TrusSteel Division

ALTERNATE PEAK CONNECTION DETAIL FOR TSC2.75 FINK TRUSSES

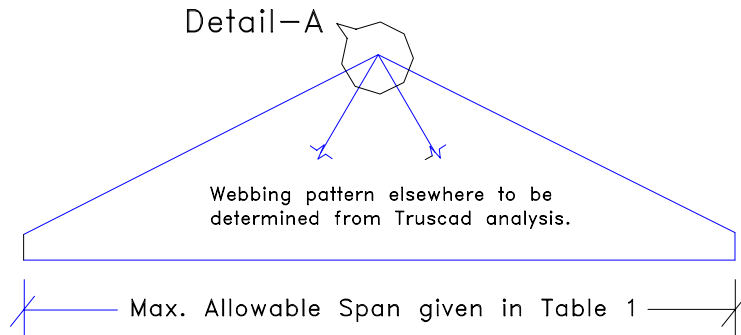

FINK TYPE TRUSS

NOTE: Symmetrical Fink type trusses with only two diagonal webs meeting at the peak are allowed.

TABLE 1

Pitch	Maximum Allowable Fink Truss Span
4/12	25'8"
5/12 to 8/12	30'0"

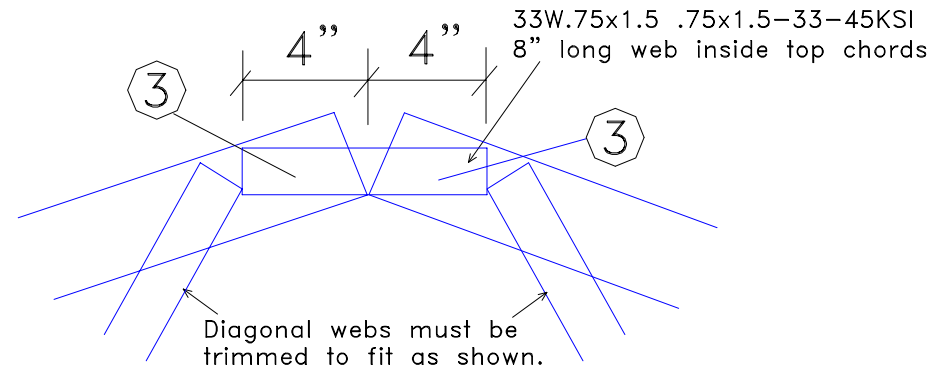

PEAK DETAIL-A

NOTE: Circle indicates minimum #14 AMD screw quantity. Refer to TrusSteel Detail Drawing No. TS011 for screw placement.

GENERAL NOTES:

- The alternate peak detail shown above could be substituted for trusses designed using Truscad with a bent-U or hinged Pitch Break Connector. Refer to Truscad output for other design details not shown here.
- Design of the Fink truss is based on the gravity loads shown in the title block below along with the following wind load criteria:
110 MPH Wind, 15.00 ft. Mean Height, ASCE 7-93, Closed Building, Exterior zone (Truss located within 4.5 ft. from end of building), 1 Mile from coast, Category I, Exposure C,
Wind TC DL = 5.0 psf, Wind BC DL = 5.0 psf.
- Length of the two diagonal webs meeting at the peak, obtained from the cut list, must have to be trimmed to fit.
- Top chord live load shown below does not represent a snow load. Contact Alpine engineering department if snow controls top chord live load.

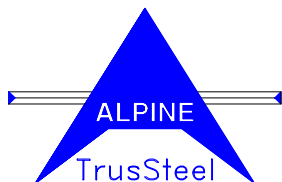

****WARNING**** TRUSSES REQUIRE EXTREME CARE IN FABRICATING, HANDLING, SHIPPING INSTALLING AND BRACING. UNLESS OTHERWISE INDICATED, TOP CHORD SHALL HAVE PROPERLY ATTACHED STRUCTURAL PANELS AND BOTTOM CHORD SHALL HAVE A PROPERLY ATTACHED RIGID CEILING.

****IMPORTANT**** FURNISH A COPY OF THIS DESIGN TO THE INSTALLATION CONTRACTOR. BRACING DEPICTED ON THIS DESIGN IS ONLY FOR LATERAL SUPPORT OF TRUSS MEMBERS TO REDUCE BUCKLING LENGTHS. ALL DESIGN, ATTACHMENT AND INSTALLATION OF TEMPORARY AND PERMANENT BRACING, TO RESIST LATERAL FORCES AND HOLD TRUSSES PLUMB, SHALL BE THE RESPONSIBILITY OF OTHERS. ALPINE ENGINEERED PRODUCTS, INC. SHALL NOT BE RESPONSIBLE FOR ANY DEVIATION FROM THIS DESIGN OR HANDLING, SHIPPING, INSTALLING, AND BRACING OF TRUSSES. AN ENGINEER'S SEAL ON THIS DRAWING APPLIES ONLY TO DESIGN OF THE TRUSS DEPICTED HERE AND SHALL NOT BE RELIED UPON IN OTHER WAY.

TC LL	20.0	PSF	TRUSSTEEL DETAIL	
TC DL	15.0	PSF		DATE 11/22/99
BC DL	10.0	PSF		DRWG TSO21
BC LL	0.0	PSF		-ENG
TOT.LD.	45.0	PSF		ALPINE ENGINEERED PRODUCTS
				TrusSteel Division
SPACING	24"	O.C.		